

VANNCAMP INSTALLATION GUIDE

REAR DOOR TIRE CARRIER

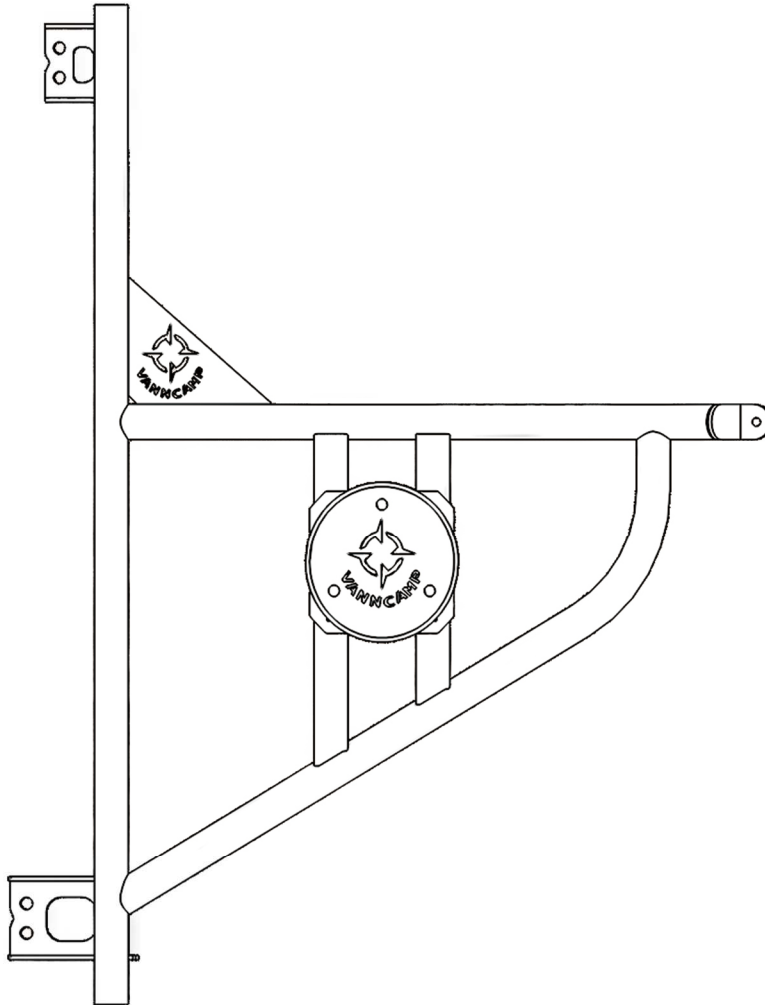

TOOLS REQUIRED

- Open-end Wrench

AT1: M10 *1 AT2: M12 *1

- T-Handle Wrench

AT3: 5/16-18 *1

INSTALL INFO: 1 HOUR

Certain installation steps may necessitate additional assistance. Some steps require 3 people to complete.

IMPORTANT: INSPECTION UPON ARRIVAL

Upon delivery, carefully inspect the product and its packaging to verify completeness and identify any potential damage. Should you discover missing components or damage, please contact us immediately at

support@vanncamp.com

MANDATORY READING

Before vehicle attachment, ensure all vanncamp products are correctly assembled and securely fastened. Improper attachment poses a significant risk of vehicle accidents, potentially causing serious bodily injury or fatality. Customers are solely responsible for the assembly and secure installation of vanncamp products, including pre-use verification of mounting points and regular inspection for wear or damage. Employing a professional installer for aftermarket accessories is highly recommended. If you are not mechanically proficient or lack familiarity with installation procedures, professional installation is required. This responsibility is critical for the safety of all involved and must be treated with utmost seriousness.

PACKAGE CONTENTS

A1

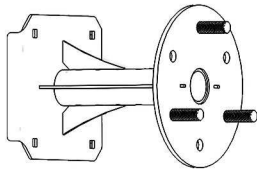

WHEEL BRACKET

QTY-1

A2

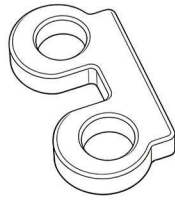

UPPER HINGE CONNECTOR

QTY-1

A3

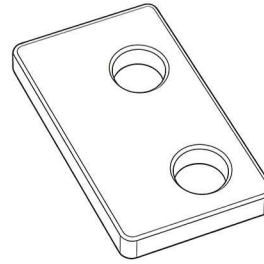

LOWER HINGE CONNECTOR

QTY-1

A0

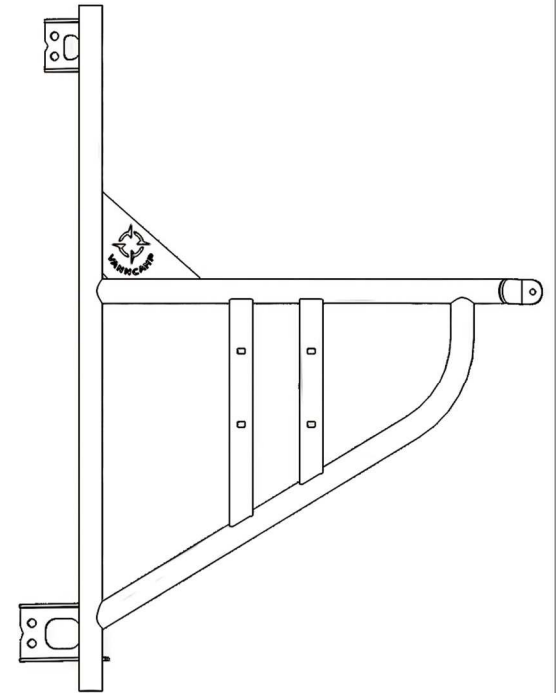

TIRE CARRIER FRAME

QTY-1

A4



TIRE LOCKING PLATE (2)

QTY-1

A5

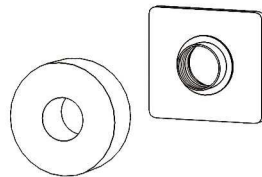

TIRE CARRIER MOUNTING BRACKET

QTY-1

B8

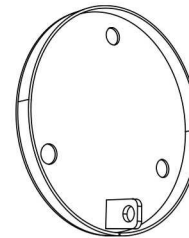

TIRE LOCKING PLATE (1)

QTY-1

HARDWARE

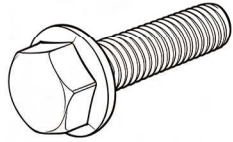

3/8-16
Hex Flange Screws
AS1

QTY-4

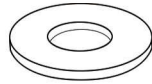

3/8
Screw Flat Washers
AS2

QTY-4

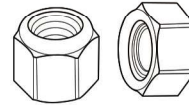

3/8
Lock Nuts
AS3

QTY-4

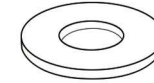

M10
Flat Washers
AS4

QTY-1

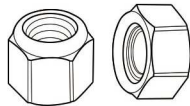

M10
Lock Nuts
AS5

QTY-1

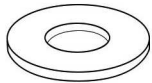

M12
Flat Washers
AS6

QTY-3

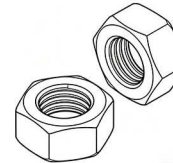

M12
Standard Hex Nut
AS7

QTY-3

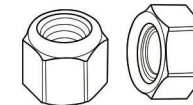

M12
Lock Nuts
AS8

QTY-3

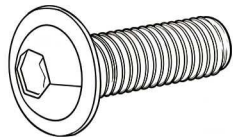

5/16-18
Carriage Bolt
AS9

QTY-4



5/16-18
Flange Hex Nut
AS10

QTY-4



M10
Hex Flange Screws
AS11

QTY-1



Rubber Bumpers

QTY-2

INSTALL

Step 1: Attach the rubber pad to the corresponding position on the outer side of the driver's side hinge.



Step 2: Take the A2 and A3 parts and place them inside the driver's side door hinge area. Be sure to differentiate their shapes and positions. The A2 part should be positioned on the upper inside, while the A3 part goes on the lower inside.

Fig. 1
UPPER HINGE



Fig. 2
LOWER HINGE



Fig. 3
UPPER HINGE

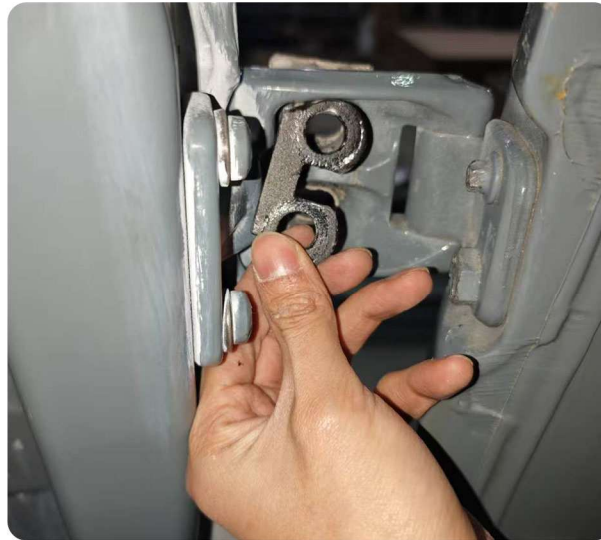

Fig. 4
LOWER HINGE



INSTALL

Step 3: Use connectors AS1, AS2, and AS3 to install parts A2 and A3, then tighten them with the AT1 and AT2 wrenches.

Note: The right-side mounting hole (A5) needs to be pre-drilled.

Step 4: Use AS4, AS5, and AS11 to install Part A5. Position the support of A5 so it sits flush against the outer side of the door. Place the A5 washer on the inner side of the door.

Fig. 5

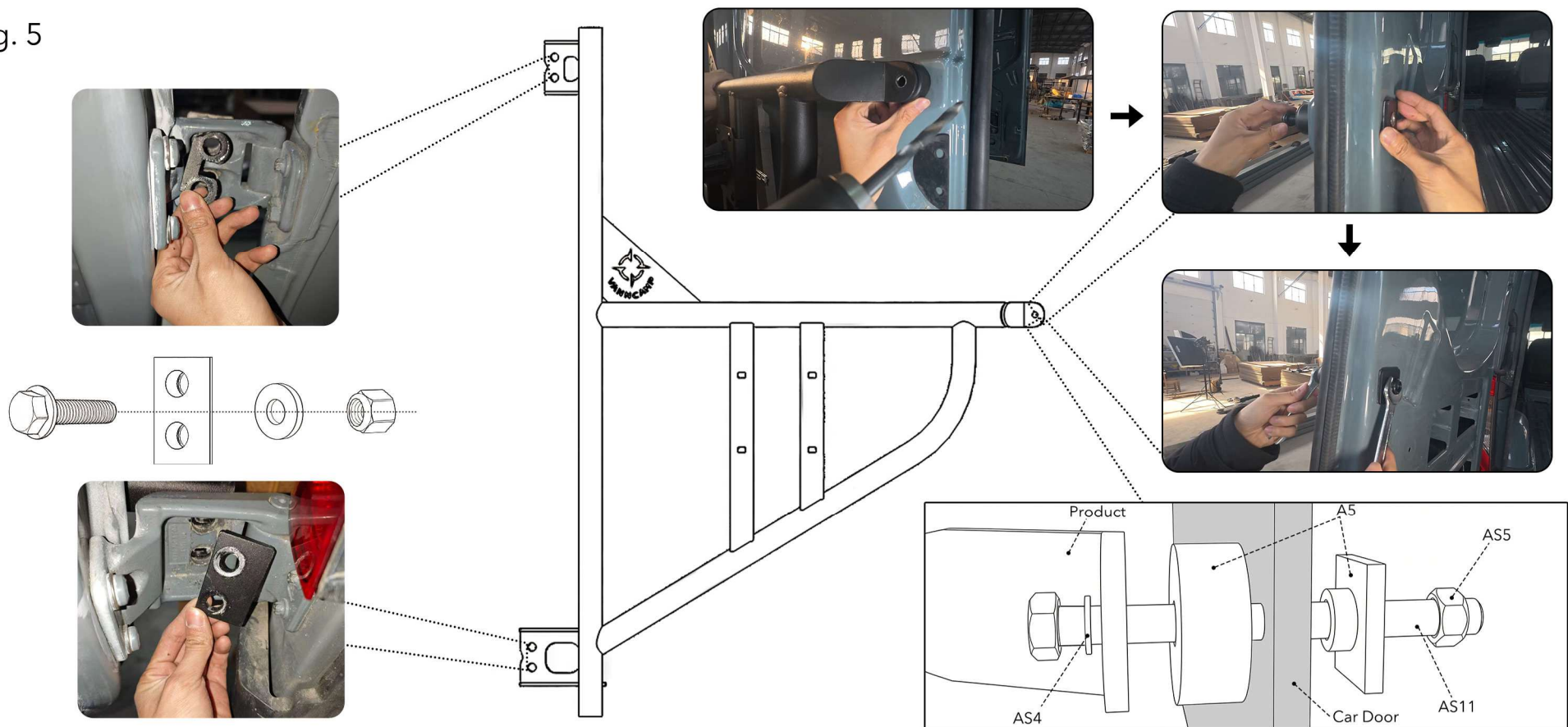

INSTALL

Step 5: Use the 5/16" bolts and 5/16" flange hex nuts to attach the wheel bracket to the tire carrier.

Fig. 6

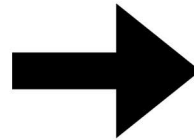

INSTALL

Step 6: Install the Tire: Align the center holes of the tire with the studs on the wheel bracket, then mount the tire in place. Secure the tire using Tire Locking Plate (1) and M12 standard hex nuts.

Fig. 7

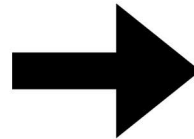

INSTALL

Step 7: Install Tire Locking Plate (2) using M12 lock nuts and flat washers.

Fig. 8

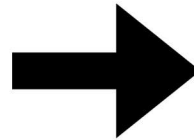

INSTALL

Step 8:

Optional

Installation is complete. Add your own lock to the tire locking plate for extra security.

Lock not included.

Fig. 9



IN THE END

Show Us Your Adventures!

We love seeing VANNCAMP gear out in the wild! Share your photos by tagging @vanncamp on social media, or email them directly to us at support@vanncamp.com. We enjoy featuring our community's journeys!

Tell Us What You Think! As fellow van enthusiasts, we're eager to hear about your experience.